

# 54-2700 Series

## Regulators - Relief / Backpressure

D54271905X012

### Specifications

For other materials or modifications, please consult TESCOM.

#### OPERATING PARAMETERS

Pressure rating per criteria of ANSI/ASME B31.3

##### Maximum Inlet Pressure

**Air Loaded:** 500 psig / 34.5 bar

**Dome Loaded:** 5500 psig / 379 bar

**Spring Loaded:** 500 psig / 34.5 bar

##### Design Proof Pressure

150% of maximum operating

##### Maximum Air Operator Pressure

100 psig / 6.9 bar

##### Operating Temperature<sup>1</sup>

-40°F to 165°F / -40°C to 74°C

##### Internal Leakage

Bubble-tight

##### Flow Capacity (main valve)

$C_v = 5.0$

#### MEDIA CONTACT MATERIALS

##### Body

303 and 316 Stainless Steel

##### Seat

Glass Filled Peek, Vespel® SP1

##### O-Rings

Buna-N, Viton®, Ethylene Propylene

##### Back-up Rings

Teflon®

##### Remaining Parts

303 Stainless Steel

#### OTHER

##### Cleaning

CGA 4.1 and ASTM G93

##### Weight (approximately)

30 lbs / 13.6 kg

<sup>1</sup>. Operating temperature range dependent on O-ring material.  
Teflon®, Viton® and Vespel® are registered trademarks of E.I. du Pont de Nemours and Company.



SPRING LOADED

TESCOM 54-2700 Series high flow backpressure regulator. The soft seat allows for hydraulic or pneumatic service. Optional with air load for use with the TESCOM ER5000 Electropneumatic Controller.

### Applications

- Process control
- High flow pump discharge control
- Hydraulic test stands

### Features and Benefits

- Available in air, dome, and spring loaded versions
- Compatible with TESCOM ER5000 Electropneumatic Controller (air load only)
- High flow:  $C_v = 5.0$
- 500 or 5500 psig / 34.5 or 379 bar maximum controlled pressure range

54-2700 Series Regulator Drawing

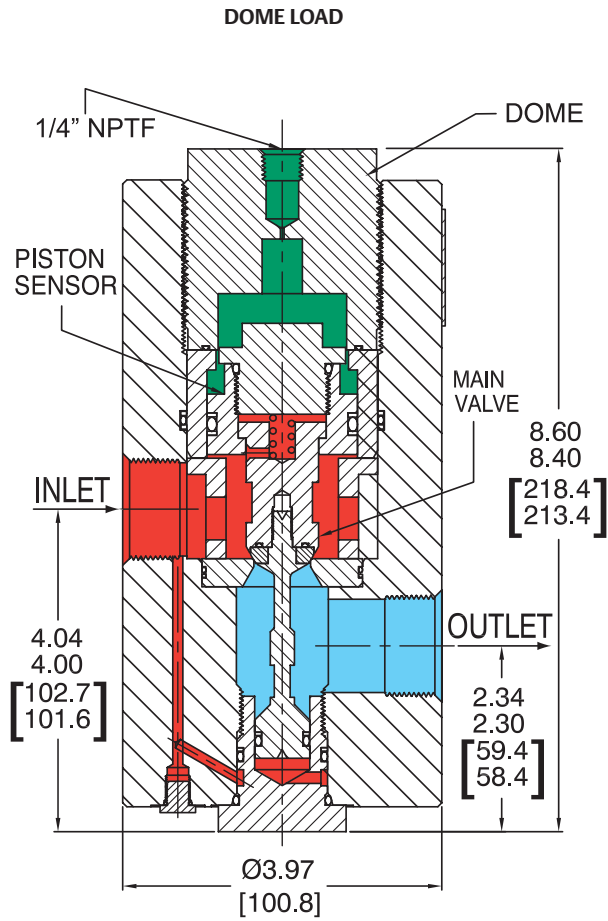

SPRING LOAD

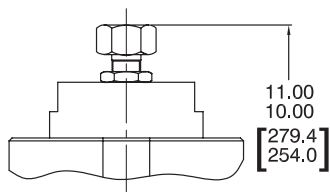

AIR LOAD

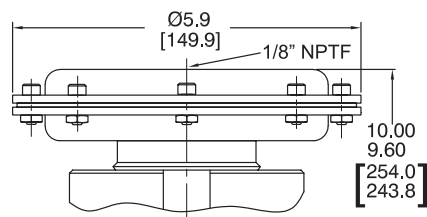

All dimensions are reference & nominal  
Metric [millimeter] equivalents are in brackets

### 54-2700 Series Regulator Flow Charts

For more information on how to read flow curves, please refer to the Flow Curves and Calculations document (debul2007x012) in the TESCOM catalog or on [www.tescom.com](http://www.tescom.com).

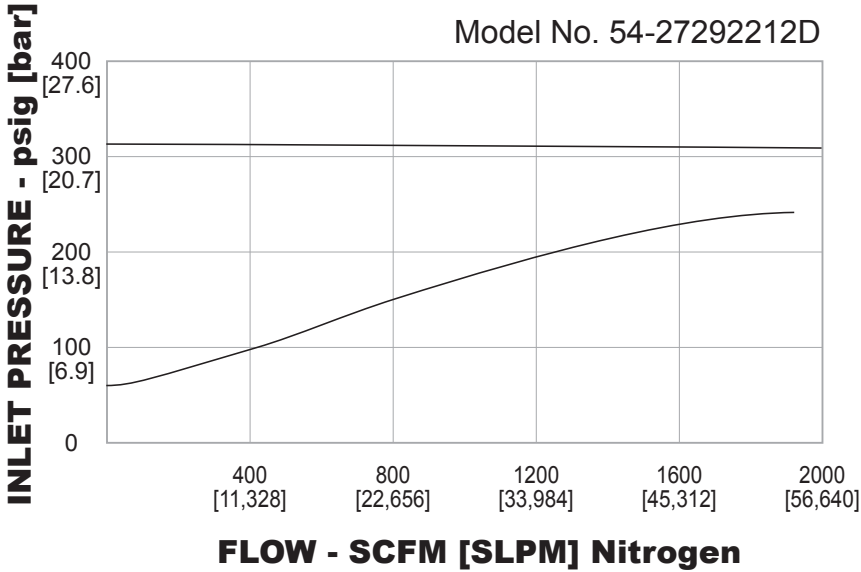
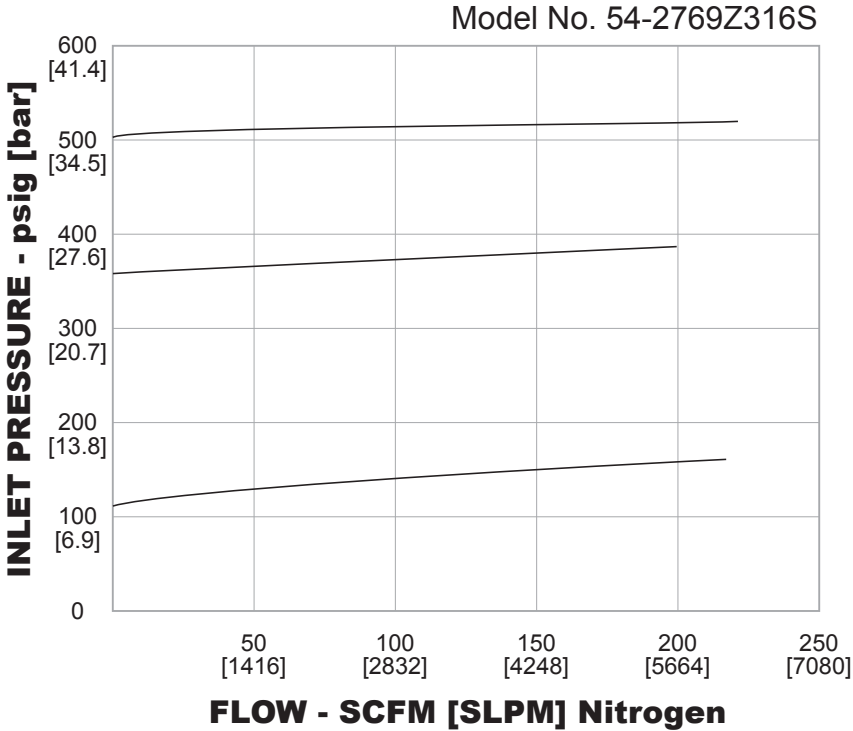

## 54-2700 Series Regulator Part Number Selector

**i Learn more about common options.**

For modifications, repair kits and accessories, contact factory.

Example for selecting a part number:

BASIC SERIES	BODY MATERIAL	CONTROL PRESSURE	SOFT GOODS MATERIAL			INLET AND OUTLET PORT TYPE	PORT SIZE	LOADING OPTIONS
			O-RINGS	SEAT	TEMPERATURE			
54-27	2 – 303 Stainless Steel 6 – 316 Stainless Steel	9 – 500 psig / 34.5 bar (5500 psig / 379 bar for dome load only)	T – Viton® Z – Ethylene Propylene D – Buna-N V – Viton®	Glass Filled Peek Glass Filled Peek Glass Filled Peek Vespel® SP1	-15°F to 300°F -26°C to 149°C -40°F to 250°F -40°C to 121°C -40°F to 165°F -40°C to 74°C -15°F to 300°F -26°C to 149°C	1 – SAE* 2 – NPTF 3 – MS33649	16 – 1"	A – Air D – Dome S – Spring
						*Body diameter is 4.50"		



**WARNING!** Do not attempt to select, install, use or maintain this product until you have read and fully understood the *TESCOM Safety, Installation and Operation Precautions*.

D54271905X012 © 2014, 2017 Emerson Process Management Regulator Technologies, Inc. All rights reserved. 08/2017.  
 Tescom, Emerson Process Management, and the Emerson Process Management design are marks of one of the Emerson Process Management group of companies. All other marks are the property of their respective owners.

