

CONSIEVE® METV TFF CASSETTES AND STAINLESS STEEL HOLDERS

High efficiency Tangential Flow Filtration (TFF) with micro filtration PVDF cassette membranes, holders, and systems

CONSIEVE® METV TFF CASSETTES, AND STAINLESS STEEL HOLDERS

Consieve® METV Tangential Flow Filtration (TFF) Cassette membranes have high retention efficiency and are easy to clean/install. The cassettes are available in a wide range of configurations. Due to their design, it is easy to amplify/increase cassette stacking to meet specific process requirements. The inner gaskets make installation/cleaning/storage/replacement quick and easy. The configurable low working volume and high efficiency ensure cost-effective product yields.

Stainless steel holders and complete custom systems enable use of the TFF cassettes to meet a multitude of process and application requirements.



SPECIFICATIONS

Membrane	PVDF
Material Features	Low protein binding and high product yield with superior flow rates.
PH Range	Broad chemical compatibility: pH 2-11
Pore Size	0.1/0.2/0.45/0.65 µm
Operating Temperature Range	4 - 50°C
Max. Operating Pressure	0.6 MPa (6.0 bar, 87 psi) at 25°C

TYPES	AVAILABLE SIZES	APPLICATIONS	NOTES
LA (Lab)	0.11 m ²	R&D, Pilot Production	Membrane Cassette; Stainless Steel Holder required
FL (Flow)	0.5 cm ² 2.5 m ²	Pilot Production, Large Scale Production Pilot Production, Large Scale Production	

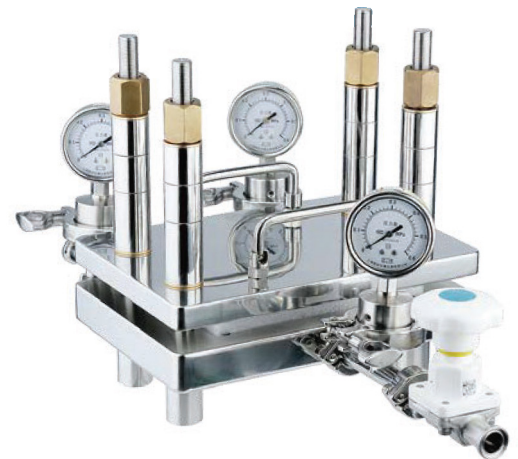

CONSIEVE METV TFF CASSETTES - ORDERING INFORMATION

EXAMPLE: **MFDFLVM10250P** = PVDF, Large Scale Format, 0.1 μm , 2.5 m^2

MF **D**
Micro Filtration
Membrane
D = PVDF

V
Format
LA = Lab, Pilot Production
FL = Flow, Pilot Production,
 Large Scale Production

Pore Size
M10 = 0.1 μm
M20 = 0.2 μm
M45 = 0.45 μm
M65 = 0.65 μm

P
Effective Filtration Area
LA Format:
010 = 0.1 m^2
FL Format:
050 = 0.5 m^2
250 = 2.5 m^2

LA Format

010



FL Format

050



250



Filtration Area	0.1 m^2	0.5 m^2	2.5 m^2
Thickness	17 mm	17 mm	84 mm
Width	56 mm	172 mm	172 mm
Length	205 mm		
Flow Path Length	172 m		
Feed/Retention Port Dia.	11.7 m		
Permeate Port Dia.	66 m		

TFF SYSTEMS

Cobetter is able to design TFF systems based on customer specifications and requirements for pilot labs and process systems.



CONSIEVE STAINLESS STEEL HOLDERS - ORDERING INFORMATION

EXAMPLE: **H-CFH01ST15SAXP** = 0.1m², 316L, 3/4" Tri Clamp, with silicone seals, mirror polish, and design pressure of 0.6 Mpa

H-CFH



Effective Filtration Area

01 = 0.1 m² (LA Format)

05 = 0.5 m² (FL Format)

S

Filter Plate Material

S = 316L



I/O

T15 = 1/2" Tri Clamp (DN15)

T20 = 3/4" Tri Clamp (DN20)

T38 = 1.5" Tri Clamp (DN38)

S

Seals

S = Silicone

A

Surface Finish

A = Mirror Polish

X

Design Pressure

X = 0.6 Mpa (87 psi)

P

Application

P = Pharmaceutical



SIZE A HOLDER

Holds Cassettes Sizes: LA Format 001 & 010

Weight: 5 kg (11 lb)

Note: Can hold up to 5, 010 (0.11m²) units.

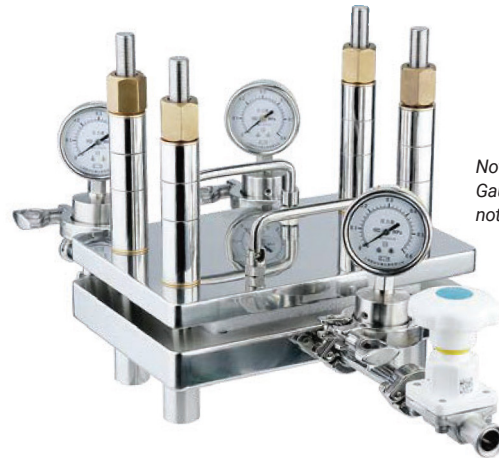

Note:
Gauges and valves
not included

SIZE B HOLDER

Holds Cassettes Sizes: FL Format 050 & 250

Weight: 24 kg (53 lb)

Note: Can hold up to 5, 050 (0.46m²) units.

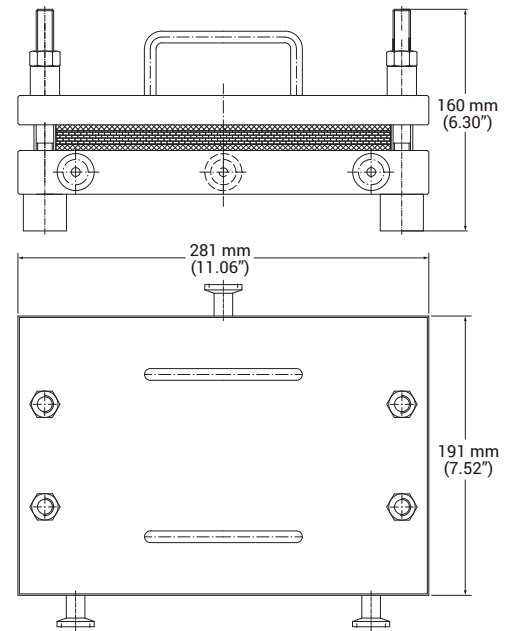
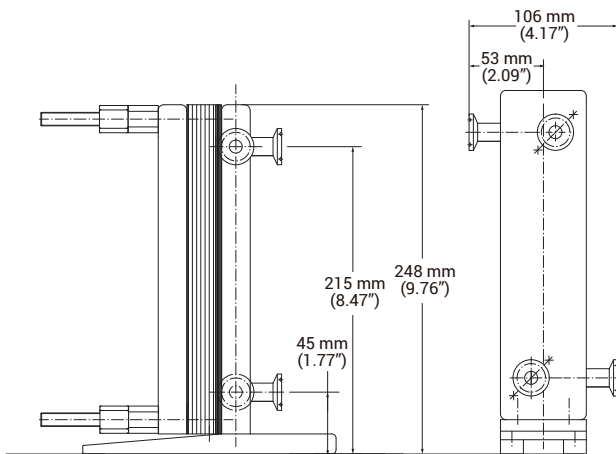

BANNER INDUSTRIES IS THE EXCLUSIVE DISTRIBUTOR FOR COBETTER PRODUCTS IN THE USA
Visit www.bannerindustries.com and select the Contact Us link to find the location nearest you. The Banner Industries of N.E., Inc. Terms and Conditions of Sale apply and are fully and expressly incorporated herein by reference and constitute a part of any contract for the purchase of the products described herein.

www.bannerindustries.com | Technical Sales: filtration@bannerindustries.com

CBBPP1222 Rev. 05162022

Copyright © 2022 Banner Industries, Inc. All rights reserved.
Consieve® is a registered trademark of Cobetter Filtration Equipment Co., Ltd